



Radiant Barrier USA
Innovating Reflective Technology

The Reflective Insulation Solution

Product Information

PolyWhite / Bubbles / Metalized Foil / EPE Foam
/ Bubbles / Metalized Foil

Two layers of 2/5" durable extra large air bubble film with a core of 1/5" EPE foam laminated with two layers of reflective metalized film and layer of white barrier polyethylene



Triplex Single



- 1 PolyWhite
- 2 Bubbles
- 3 Metalized Foil
- 4 EPE Foam
- 5 Bubbles
- 6 Metalized Foil



* Depends on the interior of the metal building\ frame size and the available sealed air spaces provided.
 ** The R-value includes 1"-1 1/2" of air space (using 1" foam spacers). See installation instructions for more details.
 *** This application consists of PolyShield Insulation and mass insulation. See installation instructions for more details.



- PolyWhite
- Bubbles
- Metalized Foil
- EPE Foam
- Bubbles
- Metalized Foil

What You Should Know About R-values

A general remark for home users: The chart shows an estimated and potential R-Value (Heat Resistance) of Triplex Single insulation in metal buildings. R-Value of reflective products depending on air film size, temperature, condition, and air flow directions (up/down/horizontal). For a complete R-Value analysis, please contact your local distributor or contact us at 972-836-4829

Product Specifications : TRIPLEX Single

Contact Temperature Range	-60°F to 180°F [-51°C to 82°C]
Thickness	1" nominal
Emittance (Metalized Side)	E=5%
Water Vapor Transmission	.02 perms ASTM E96
Puncture Resistance	60 lbs/in
Tensile Stress (kPa)	TD:3123 / MD:3073
Tear Strength (kN/m)	TD:78.09 / MD:76.83
Pliability	No Cracking
Linear Shrinkage	None
Mold and Mildew	No Growth
Flame Spread	< 25 ASTM E84- 21a
Smoke Development	< 450 ASTM E84-21a
Fire Rating	Class A / Class 1

PolyShield R-Values	Triplex Single
Attic - Vented	Check for R value
Attic Space* (with 2x 3"- 4" air spaces/ heat flow down)	R-11.5
Metal Buildings*	R-4.8 Up R-10.1 Down R-5.2 Wall
Post Frame Buildings*	R-4.8 Up R-8.1 Down R-5.2 Wall
Wall \ CrawlSpace \ Basement Masonry **	R-10.0
Wall - Garage	R-6.2
Wall - 2x6 Stud with R12 batt***	R-22.0



Radiant Barrier USA
Innovating Reflective Technology

Triplex Single

Advantages :

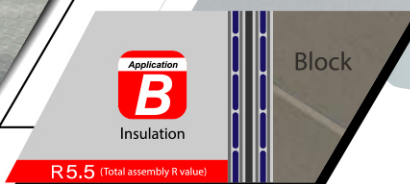
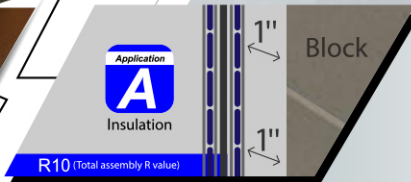

95%

REFLECT 95% OF RADIANT HEAT (SILVER SIDE)

BE ACTIVE!
USE REFLECTIVE INSULATION NOW

